

### CANALON H° A°

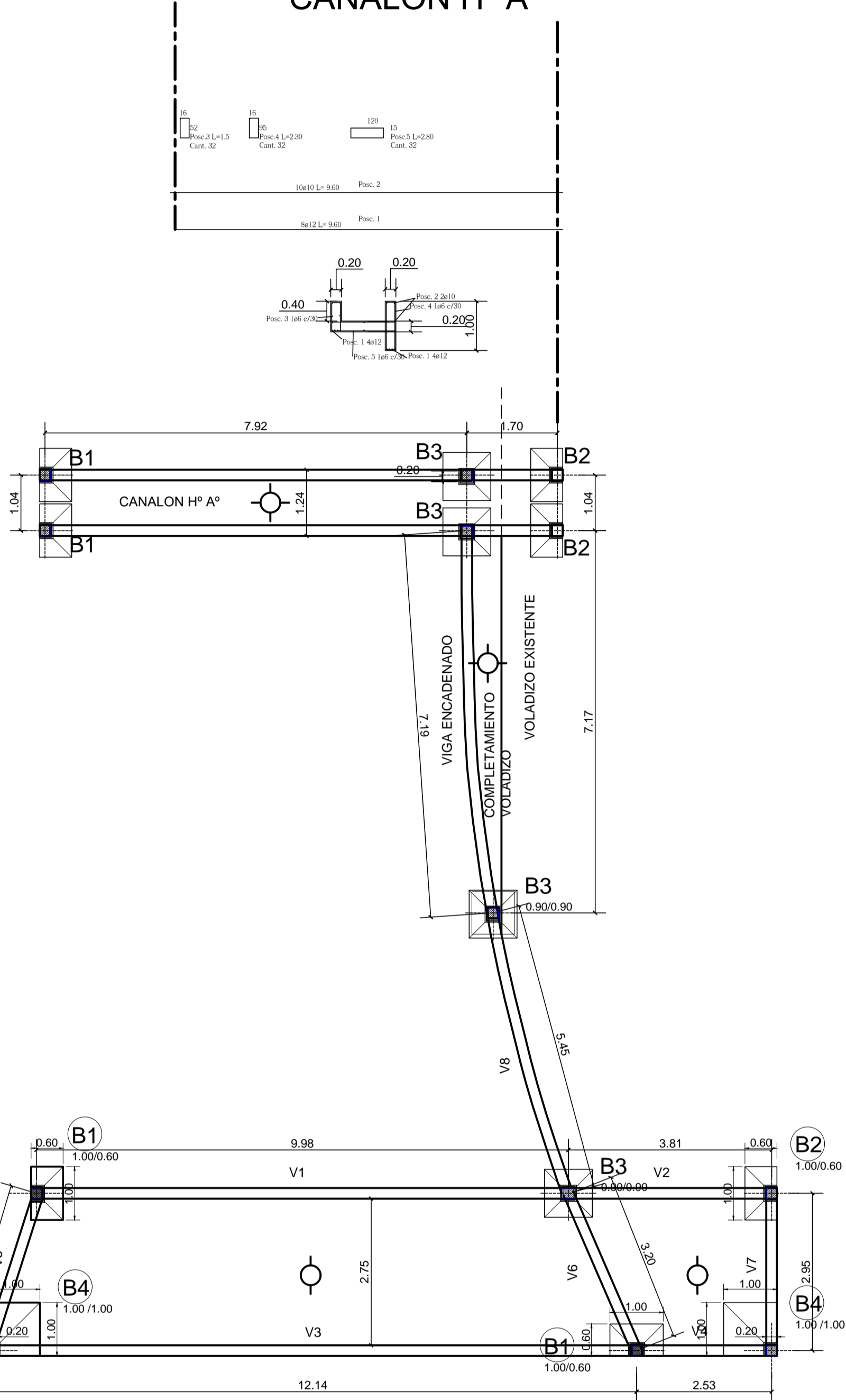

### VIGAS H° A°

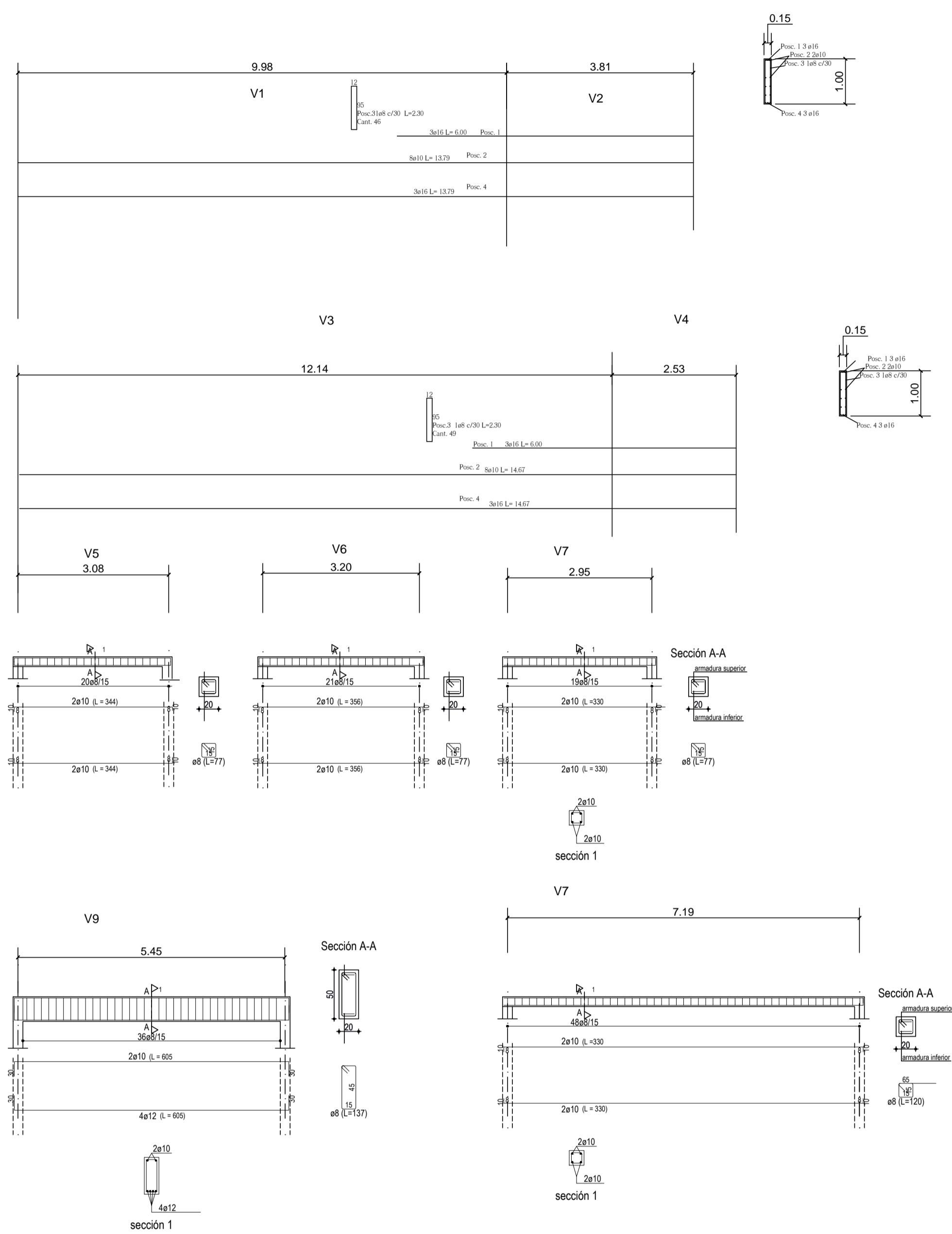

### BASES H° A°

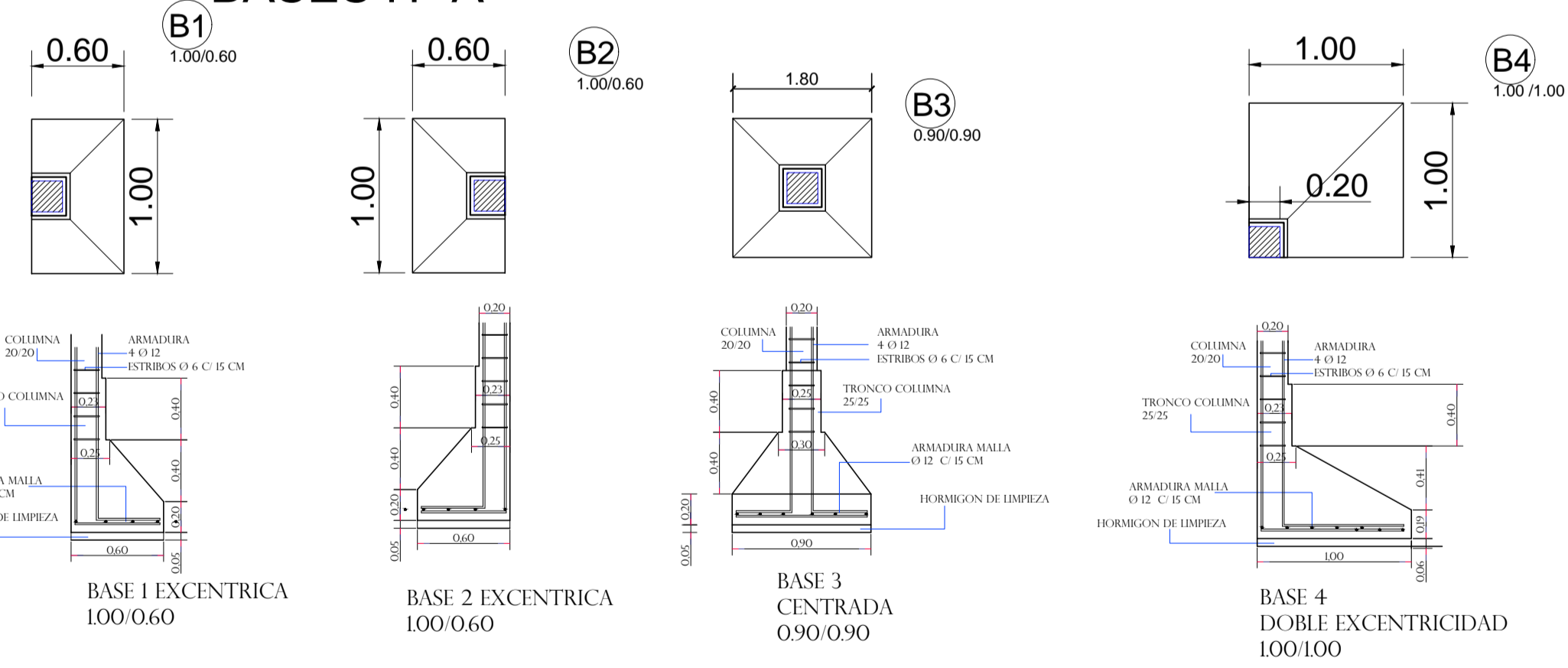

### LOSA H° A° e= 12 cm

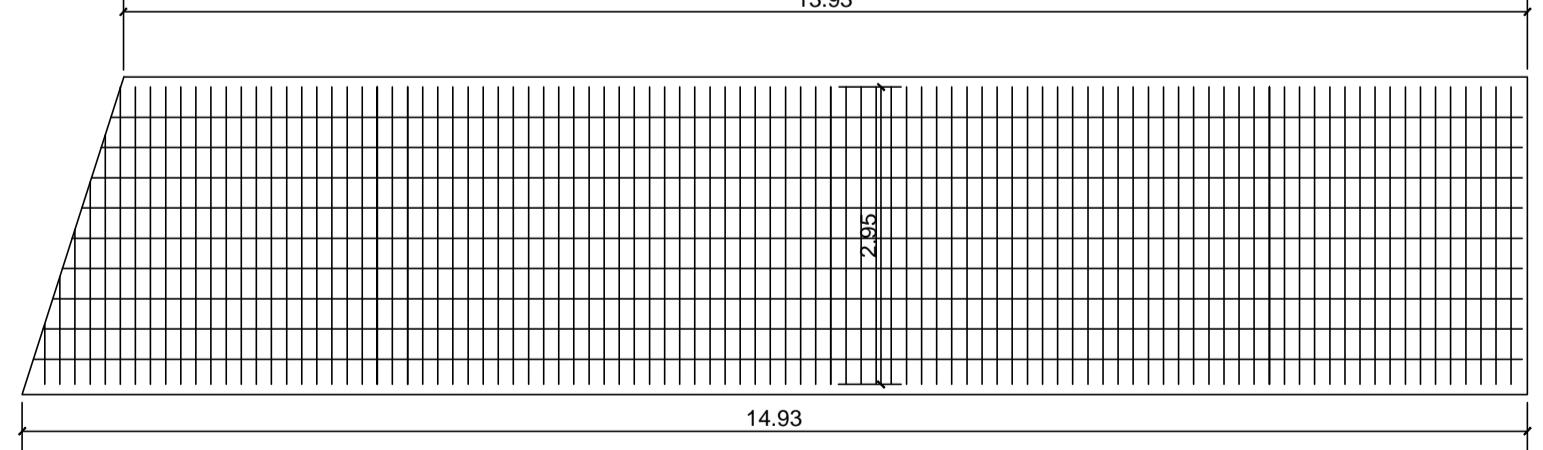

### DETALLE BANCO HORMIGON

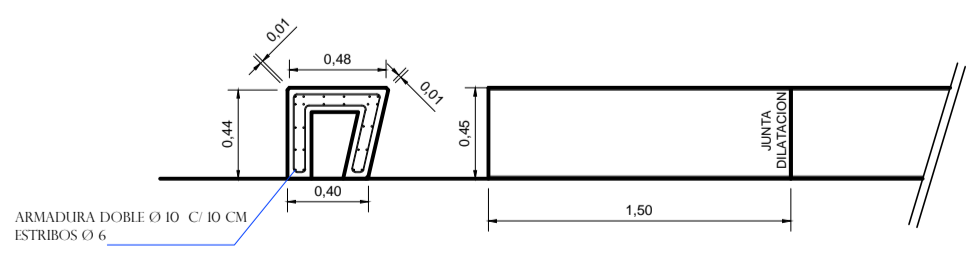

|  |  |                     |
|--|--|---------------------|
|  |  | 1<br>1              |
| OBRA : RECICLADO ACCESO PRINCIPAL<br>EDIFICIO EXFANAZUL BELGRANO N° 322 - AZUL |  | DIBUJO:<br>E.O.D.   |
| PLANO : ESTRUCTURA DE HORMIGON   |  | ESCALAS :<br>1:75   |
| Arq. OSVALDO D. DADIEGO<br>Dirección Gral de Obras                             |  | FECHA:<br>OCT. 2020 |